

Zoning Map

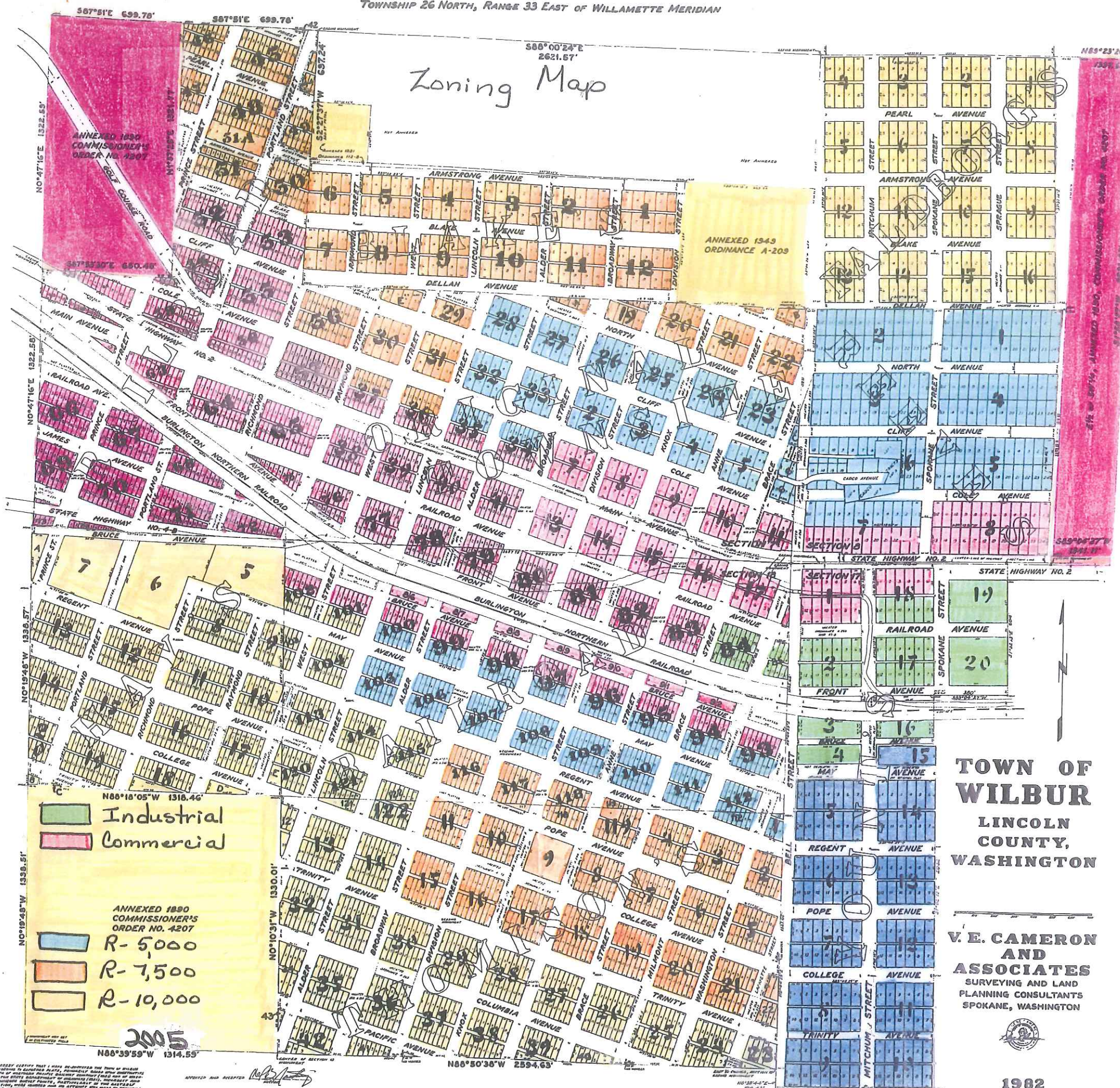

Industrial
 Commercial
 R-5,000
 R-7,500
 R-10,000

ANNEXED 1890
 COMMISSIONER'S
 ORDER NO. 4207

2005

TOWN OF WILBUR
 LINCOLN COUNTY,
 WASHINGTON

V. E. CAMERON AND ASSOCIATES
 SURVEYING AND LAND PLANNING CONSULTANTS
 SPOKANE, WASHINGTON

